

Low Differential Air Pressures

## DIFFERENTIAL PRESSURE INDICATORS



- Replaces water column manometers and VAV Flowmeters
- Panel Mounting
- Two adjustable trip levels (Relays) and Lamps
- IP65 Front cover option
- DC operated with optional AC Adaptor
- LCD Backlit display
- Analogue Output 4-20 mA
- RS232C Output

### DESCRIPTION

The FC0318 series of digital pressure indicators are panel mounted dc powered electronic manometers for the measurement of differential air or gas pressures. They cover low ranges in 6 basic models from 0-50 Pascals up to 0-20 kPa and equivalent engineering units. The instruments can be configured via the front panel keypad to show a variety of display options including volume and mass flow and velocity as well as differential pressure units. Additionally the FC0318 can be set to a precise range within 10-100% of the basic models. The display is a backlit LCD with large clear indication. Furthermore the FC0318 has 2 adjustable relay contacts with variable hysteresis and red and green lamps to indicate level. There is adjustable damping or time constant too. Options include an AC adaptor 90-250 vac and an RS232 Serial Output.

Applications include the indication of air or gas pressures and the flow measurement of injectors or jets, they replace water column manometers or variable area Flowmeters

# Low Differential Air Pressures

## DIFFERENTIAL PRESSURE INDICATORS

### MODELS

<b>Model</b>	<b>FC0318</b>
Model 1	0-.2000 INH2O
Model 2	0-.6000 INH2O
Model 3	0-2.000 INH2O
Model 4	0-10.00 INH2O
Model 5	0-40.00 INH2O
Model 6	0-80.00 INH2O

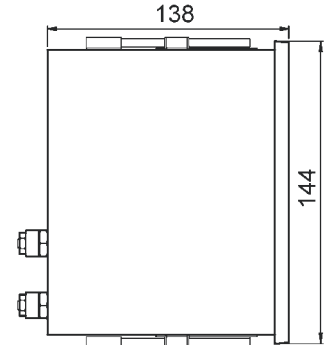
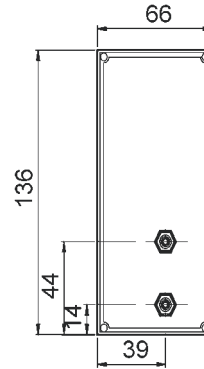

### Features

Each measuring range is available as shown above with adjustable double trip levels by contact changeover. Each range can be scaled according to requirement and the indicated engineering units configured using the front panel membrane keypad or the FC0301 software utility programme and cable. A front panel clear rubber membrane is optional to give IP65 protection.

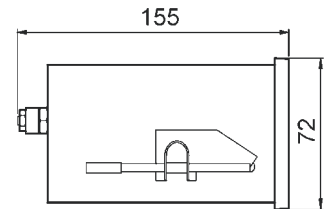

### Controls and connections

Zero, range damping (time constant) relay contact positions and other configurable settings are controlled by the front panel membrane keypad or by the optional FC0301 software utility programme and cable. The AC power adaptor connects through the rear panel connector. Pneumatic connections by 6 x 4mm OD compression fittings. Optional RS232C output through rear panel 9 pin 'D' socket.

### SPECIFICATION

Accuracy of calibration	±0.25% on reading
Resolution	±0.05%, ±1 digit
Compatibility	Air and non-corrosive gases
Hysteresis	Less than 0.1%
Temperature co-efficient on zero	0.5% FS per 10°C
Static pressure rating	±1 bar
Supply voltage	24 Vdc or 90-250 Vac with optional AC Adaptor
Analogue output	4-20 mA
Housing material	Glass reinforced fibre (Noryl)
Housing rating	IP50. With optional front cover IP65
Dimensions	5.7" wide x 2.8" high x 5.9" deep
Weight	1.5 lbs.
Relay contact rating	2 amp at 50 Vac/30 Vdc

Agent's Stamp:

### Furness Controls